

Imperial Valley Campus

Administration

Dean: Stephen B. W. Roeder
Associate Dean for Academic Affairs: Stephen A. McNett
Assistant Dean for Student Affairs: Miguel Rahiotis
Director of Business and Financial Services: Irma Martinez
Director of Advancement: John Renison

Faculty

Emeritus: Ayala, Baldwin, Ballesteros, Elizondo, Fatemi, Harmon, Hill, King, Merino, Polich, Spencer, Varela-Ibarra
Professors: Dunn, Medeiros, Neumann, Reyes, Roeder, Ryan, Shumaker
Associate Professors: Amaral, Castañeda, Champion, Coates, Garrison, Sabath, Stampfl, Verzi
Assistant Professors: Boime, Herrera, Itzá, King, Perner, Ponce, Ramirez-Pimienta, Yoo
Lecturers: Cook, Fuentes, Livingston, McNett, Murphy

General Information

The Imperial Valley Campus is a branch campus of San Diego State University serving the desert area of southeastern California. It is accredited as an integral division of SDSU and operates under the same academic calendar. Established in 1959 by an act of the State legislature, the campus has two locations in the Imperial Valley: Calexico and Brawley. Offering the last two years of undergraduate education, graduate programs, and fifth year credential programs for teacher preparation, the campus accepts students who have at least 56 transferable units from community colleges or other accredited institutions. The Imperial Valley Campus offers students the advantages of smaller classes and individual contact with the faculty. The Imperial Valley Campus faculty are multinational in their classroom orientation and background. Interactive television provides students in Calexico the opportunity to participate in various classes broadcast live from the campus in San Diego. The Imperial Valley Campus schedules its classes to meet once a week in three-hour blocks so that students who work full time can earn 9-12 units a semester by attending classes once or twice a week. Occasional classes are also offered on the weekends.

The Imperial Valley Campus is located in Imperial County which has a population of approximately 140,000 people. Calexico is 120 miles east of San Diego, 60 miles west of Yuma, Arizona and 120 miles south of Palm Springs. Interstate 8 and State Highways 111 and 86 connect the County to the rest of the country and state. In 2003-2004, we proudly expanded our campus to two sites in order to better serve our students and our community. The Calexico location, six blocks from the Mexican border, provides the opportunity for involvement in a bicultural environment. Just across the border is Mexicali, a city of more than one million people. The Brawley location is 24 miles north of the Calexico site. It is surrounded by rich agricultural fields, the largest industry in the Imperial Valley.

The over 900 students at Imperial Valley Campus have the opportunity to be involved in a rich campus life. Student clubs, student government, lectures, art exhibits, quad musical events, library and computer center special programs enhance the students' education at SDSU – Imperial Valley Campus.

The Imperial Valley Campus Web site is
<http://www.ivcampus.sdsu.edu>.

The telephone number is 760-768-5500.

Curricula Offered

Undergraduate Degrees

Major in business administration (agribusiness emphasis) with the B.S. degree in applied arts and sciences.
Major in criminal justice administration with the B.S. degree in applied arts and sciences.
Major in English with the B.A. degree in liberal arts and sciences.
Major in history with the B.A. degree in liberal arts and sciences.
Major in international business (Latin America and North America emphases), with the B.A. degree in liberal arts and sciences.
Major in Latin American studies with the B.A. degree in liberal arts and sciences.
Major in liberal studies with the B.A. degree in liberal arts and sciences.
Major in mathematics with the B.A. degree in liberal arts and sciences.
Major in psychology with the B.A. degree in liberal arts and sciences.
Major in public administration with the B.A. degree in applied arts and sciences.
Major in social science with the B.A. degree in liberal arts and sciences.
Major in Spanish with the B.A. degree in liberal arts and sciences.
Minor in English.
Minor in history.
Minor in linguistics.
Minor in mathematics.
Minor in political science.
Minor in psychology.
Minor in public administration.
Minor in small business management.
Minor in Spanish.

Graduate Degrees

Master of Arts degree in Education
Concentration in Educational Leadership
Concentration in Elementary Curriculum and Instruction
Concentration in Secondary Curriculum and Instruction

In addition, the Imperial Valley Campus, in cooperation with academic units and the Division of Graduate Affairs on the San Diego campus, offers the following graduate programs leading to advanced degrees.

Master of Public Administration
Master of Science degree in Business Administration
Concentration in International Business

Certificate Programs

Business Administration, Court Interpreting, Introductory Mathematics, Public Administration, Single Subject Mathematics, Translation Studies

Teaching Credentials

Basic: Multiple Subject Cross-Cultural Language and Academic Development (CLAD) emphasis, Multiple Subject Bilingual Cross-Cultural Language and Academic Development
(BCLAD) emphasis: Spanish, Single Subject
Specialist: Administrative Services
Special Education
(Both in conjunction with the College of Education)

For further information on any of these degrees, see the SDSU – Imperial Valley Campus Bulletin.

Freshman Scholars Program

The Freshman Scholars Program offers an opportunity for a small, select cohort of students to join their intellectual peers in a four-year university program. The courses are designed to stimulate students with excellent academic skills who seek knowledge and new perspectives. The first year curriculum provides a foundation for several majors on our campus, currently criminal justice administration, liberal studies, or psychology. The courses will also allow students to participate in a fast-track curriculum leading to a degree in liberal studies and a multiple subject credential in nine semesters.

Exchange Programs and Study Abroad

Graduate and undergraduate students at the SDSU-Imperial Valley Campus can enhance their education and cultural awareness by taking part in several of the many opportunities available to study abroad. The campus has active exchange agreements with universities in Argentina, Brazil, Croatia, Ecuador, Finland, France, Germany, Iran, Mexico, Morocco, Paraguay, Turkey, Ukraine, and the United Kingdom. Several other agreements are in process of negotiation with different academic institutions around the world, including Chile, Costa Rica, and Uruguay.

There are exchange programs for undergraduate students between the Imperial Valley Campus, the Universidad Autónoma de Baja California, and Centro de Enseñanza Técnica y Superior, that allow students to take classes at either of the participating universities and receive credit at their home institution.

In addition to IVC's own International programs, students may participate in any international programs at SDSU, including the California State University International Programs; the SDSU spring semester programs; or the International Student Exchange Program (ISEP) Consortia.

Research Centers and Institute

California Center for Border and Regional Economic Studies (CCBRES)

Kimberly Collins, Director

The California Center for Border and Regional Economic Studies (CCBRES) specializes in research on the Imperial Valley and U.S.-Mexican border region. The center collects and compiles statistics on economic, demographic, social, environmental, and trade indicators on the Imperial County, Mexicali Baja California, and the binational region. It publishes a bimonthly bulletin of indicators in the region along with in-house and sponsored analysis of border policy issues. Started in 1999, the center has created a resource for the region's residents and individuals interested in issues surrounding the U.S.-Mexican border. The center receives over 12,000 inquiries per year for information on the Imperial-Mexicali valleys.

In addition to the database and monthly bulletins, CCBRES conducts a number of sponsored research projects. The focus of recent research has included quality of life, air quality, environmental perceptions of local residents, the development of a system dynamics model for the binational region, and the capacity of governments on both sides of the border to manage air quality issues.

The center has hosted a number of conferences and workshops on border issues, ranging from trade and economics to environmental and educational issues. The center has been the primary organizer of the annual Imperial Valley Economic Development Summit. In the seventh year, this conference has been recognized as an annual, well respected event with over 200 attendees each year. This event helps to highlight San Diego State University as a provider of high quality information on the region.

The center has provided national and international recognition to the Imperial Valley Campus of San Diego State University as a source for quality border research. The Imperial Valley Campus has been designated by the U.S. Department of Agriculture as one of eight National Centers of Excellence primarily based on the activities of CCBRES.

The center's Web site is <http://www.ccbres.sdsu.edu>, e-mail address is kcollins@mail.sdsu.edu, telephone number is 760-768-5510, and FAX number is 760-768-5583.

Center for Individual and Professional Skills Development

Susanna Fuentes, Director

The Center for Individual and Professional Skills Development at San Diego State University-Imperial Valley Campus offers community programs to the Imperial and Mexicali valleys. The center presently offers English as a Second Language (ESL) in the local community and in Mexico, a teacher training program, business English for executives, and the computer and language training program (a rehabilitation program for injured workers). Additionally, the Center for Individual and Professional Skills Development presents annual conferences including the Bi-national Conference on Education and the Bi-national Youth Leadership Conference. The center has twice been the recipient of a Wellness Foundation Grant and a U.S. Department of Housing and Urban Development Grant.

Desert Farming Institute

Stephen B. W. Roeder, Director

The Desert Farming Institute at the Imperial Valley Campus of San Diego State University has two distinct components. First, a research unit explores desert farming and its potential for improving the competitiveness of agriculture in the desert southwest. Of special interest are the introduction of new crops and growing crops under low water use conditions. The second unit of the institute is the Center for the Study of International Trade in Agriculture with the objective of studying international trade in agriculture and making the results available to California and Arizona farmers.

Facilities

The Calexico campus is located on an eight-acre city block in the heart of Calexico's civic center along the Mexican border. The campus facilities create a pleasing architectural harmony of old and new structures surrounding a spacious central lawn area, the Rollie Carrillo Quad. Adjoining the quad, the expanded library, Rodney Auditorium, and John Stepling Art Gallery provide academic and cultural resources for the entire community. Other buildings include classroom buildings, the administration building, faculty offices, a computer lab, a bookstore, and the Student Union. In 2003-2004, we proudly expanded our campus to two sites in order to better serve our students and our community. The Brawley location is 24 miles north of the Calexico site. It is surrounded by rich agricultural fields, the largest industry in the Imperial Valley. Brawley houses five classrooms, including one classroom with video conference capabilities, and one computer classroom.

The library, located at the Calexico site, is designed to facilitate research and to provide a pleasant atmosphere for study. The collection is expanding and has more than 110,000 volumes, periodicals, and newspapers which support the curricula offered on the Imperial Valley Campus. Services provided include reference assistance, CD ROM databases, personal computers for word processing, full text database, Internet access, interlibrary loans, and photocopying facilities.

Computer assistance is available in the computer lab. Both Macintosh and IBM compatible systems and Internet access are also available on campus.

Transfer Center

The Transfer Center is a project that provides support services to identified and potential transfer students from accredited institutions. Information is provided by a professional counselor about programs and services available at San Diego State University, Imperial Valley Campus. The project works with all students but has as its goal to increase the number of underrepresented students in higher education. Underrepresented students are minorities, disabled, low income, and others not appropriately represented among the transfer population. For more information, call 760-768-5506 or visit the office located in Student Affairs.

Admission and Registration

To apply for admission to the Imperial Valley Campus, students must file a complete application and transcripts as outlined elsewhere in this catalog. Both completed application forms and transcripts should be sent to the Admissions Office, San Diego State University, Imperial Valley Campus, 720 Heber Avenue, Calexico, California 92231. Please

telephone 760-768-5667 for further information. Students can register on the Internet using WebPortal, but only after fees are paid. Late registration is allowed during the first two weeks of the semester. Students wishing to late register must pay registration fees plus a \$25.00 late fee.

Imperial Valley Campus Scholarships

The Imperial Valley Campus students were awarded over \$75,253 in scholarships for the 2004-2005 academic year. Information and applications for scholarships are available from the Financial Aid Office. Following is a list of scholarships established at Imperial Valley Campus:

- | | |
|---------------------------------|---------------------------------------|
| Alejandro and Florencia Nogales | Jerry Pennington |
| Board of Supervisors | Ralph and Eva Pesqueira |
| Calexico Educational Foundation | SDSU-IV International Programs |
| Cesar E. Chavez | Soroptimist International of Calexico |
| Dean's Scholars | Talbots Women's Fund |
| Enrique Camarena | Tzu Chi Foundation |
| Good Sport Howie | Zonta International Jane M. Klausman |
| HACU | |
| Imperial County Farm Bureau | |
| Joe and Dorothy Rodney | |

Endowments:

- | | |
|---------------------------------|------------------------------------|
| Anheuser-Busch Companies, Inc. | Douglas and Barbara Patiño |
| William and Susan Brandt | Joe Patiño Family |
| Enrique (Kiki) Camarena | Jerry Pennington Memorial |
| Francis and Edna Rae Frye | Ralph and Eva Pesqueira |
| Jack Hart Family | Joe and Dorothy Rodney |
| Good Sport Howie | Rotary International District 5340 |
| Herschel Hudson | Ethan A. Singer |
| Nancy A. Marlin | Stephen and Susan Weber |
| Sally McMahon/Doves | Title V |
| Alejandro and Florencia Nogales | |

Commencement

The Imperial Valley Campus holds its own commencement exercises each spring, in the Rollie Carrillo Quad, prior to commencement exercises on the San Diego campus.

Imperial Valley Campus – Calexico Campus Map

SDSU IVC Campus – Calexico
720 Heber Avenue
Calexico, CA 92231
760-768-5500

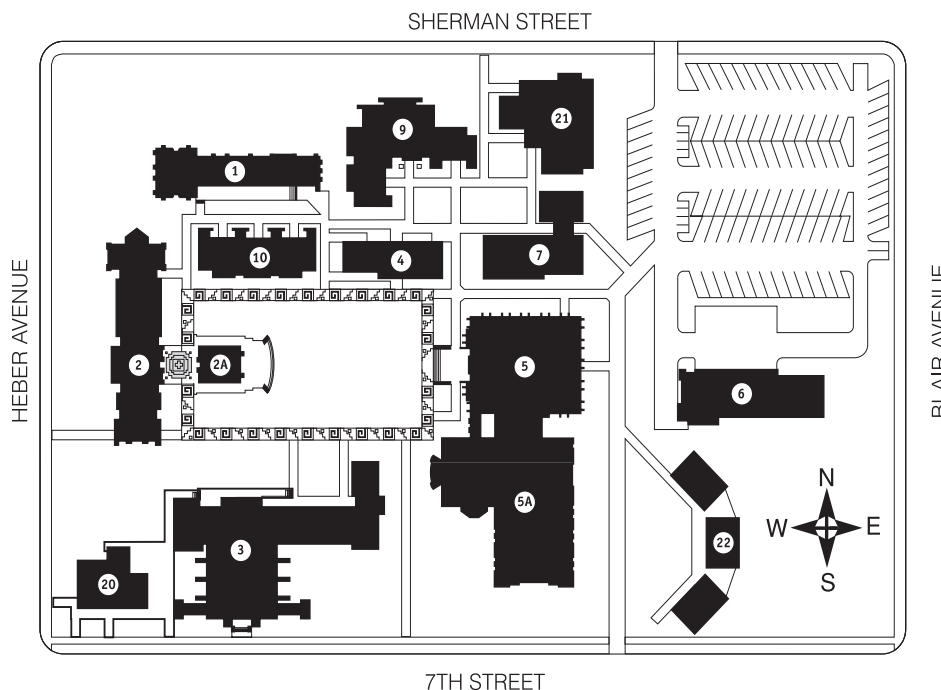

BUILDING LEGEND

- | | | |
|--|---|--|
| 1. North Classroom Building (N-101, N-102, N-106, N-108) | 4. Classroom Building (C-7, C-8, C-9, C-10) | 9. Faculty Offices: Building East (Classrooms) |
| 2. Administration Building (Administration/Academic Affairs/Business Office) | 5. Library | 10. Faculty Offices: Building West |
| 2A. Art Gallery | 5A. Library Addition | 20. Student Center |
| 3. Auditorium/ Classrooms (A-3, LA-1, LA-2, LA-3, LA-4) | 6. Physical Plant | 21. Student Affairs |
| | 7. Computer Building | 22. CLAT - Classrooms |

Imperial Valley Campus – Brawley Campus Map

SDSU IVC Campus – Brawley
560 East Highway 78
Brawley, CA 92227
760-351-0806

